

# **Design guidelines for Pharmacies**

**Pharmacy 3D models for the purpose  
of license application**



**South African  
Pharmacy Council**

**Accessible quality pharmaceutical services for all**

*Last updated 01 August 2020*

# Content

- ▶ **Purpose**
- ▶ **Legislative provisions**
- ▶ **Current GPP requirements**
- ▶ **Council approach**
- ▶ **Pharmacy models as per current GPP requirements**
- ▶ **Future models**



# Purpose

- ▶ to provide design guidelines of pharmacies for the purpose of license application;
- ▶ to address challenges presented by current 2D models;
- ▶ to make the evaluation criteria easy to understand and apply;

**Note: The guidelines are made in terms of GPP**



# Pharmacy licensing legislative provisions

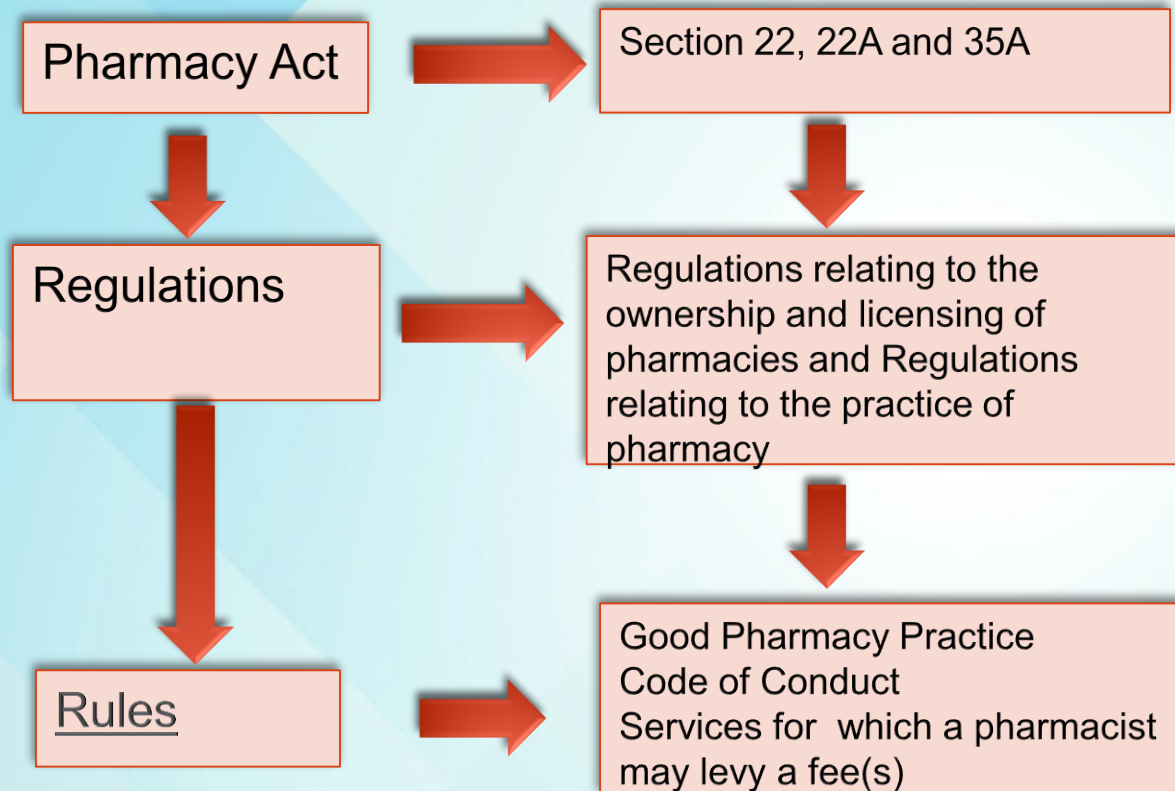

# Legislative provisions

## ► Section 22 provides for the following:

- requirements for the application and issuing of the license;
- recording of the pharmacy;
- conditions under which pharmacy may be conducted;
- right of Council to inspect such premises;
- cancelation or suspension of a license by the DG;



# Legislative provisions

- ▶ **Section 35A provides that Council may make rules:**
  - **Services which may be provided in the various categories of pharmacies**
  - **Good pharmacy practice (license evaluation criteria)**
  - **Approve the trading title or name of the pharmacy**



# Current GPP requirements

- ▶ **Minimum standards for pharmacy premises, facilities and equipment (Section 1.2 GPP)**
  - **Appearance of the pharmacy premises**
  - **Another business in a pharmacy or a pharmacy in another business**
  - **Security in a pharmacy**
  - **Control of access to pharmacy premises**
  - **Safety in pharmacy premises**





# Current GPP requirements cont...

- ▶ **Condition of pharmacy premises**
- ▶ **Construction of pharmacy premises**
- ▶ **Environment in pharmacy premises**
- ▶ **Hygiene in pharmacy premises**
- ▶ **Storage areas in pharmacy premises**
- ▶ **Dispensary**
- ▶ **Waiting area**
- ▶ **Areas for counselling and the furnishing of advice**





# Evaluation criteria

- ▶ License evaluation criteria (Rule 2.31 GPP)
  - Supporting documentation which includes amongst others
    - Professionally drawn **floor plan** indicating
      - the actual layout of the pharmacy premises drawn to scale with exact measurements,
      - pharmacy trading title and full premises address
    - **Site plan** - indicating
      - the location of the pharmacy in relation to adjoining or surrounding businesses and access to and from the premises,
      - pharmacy trading title and full premises address
  - Trading title(s)
  - Another business or practice in a pharmacy or a pharmacy in another business



# Guidelines for applicants

## ► Semi-Private Area – Rule 1.2.13 (1 to 4)

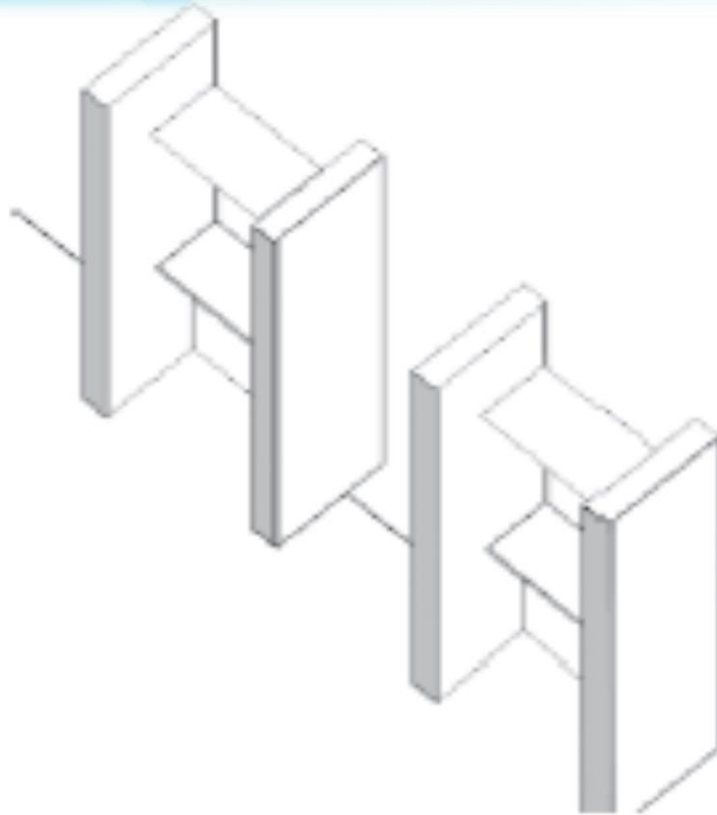

*Figure 1: Semi-private area*



# Guidelines for applicants cont...

- ▶ Waiting area with private counselling area - Rule 1.2.13 (1 to 4)

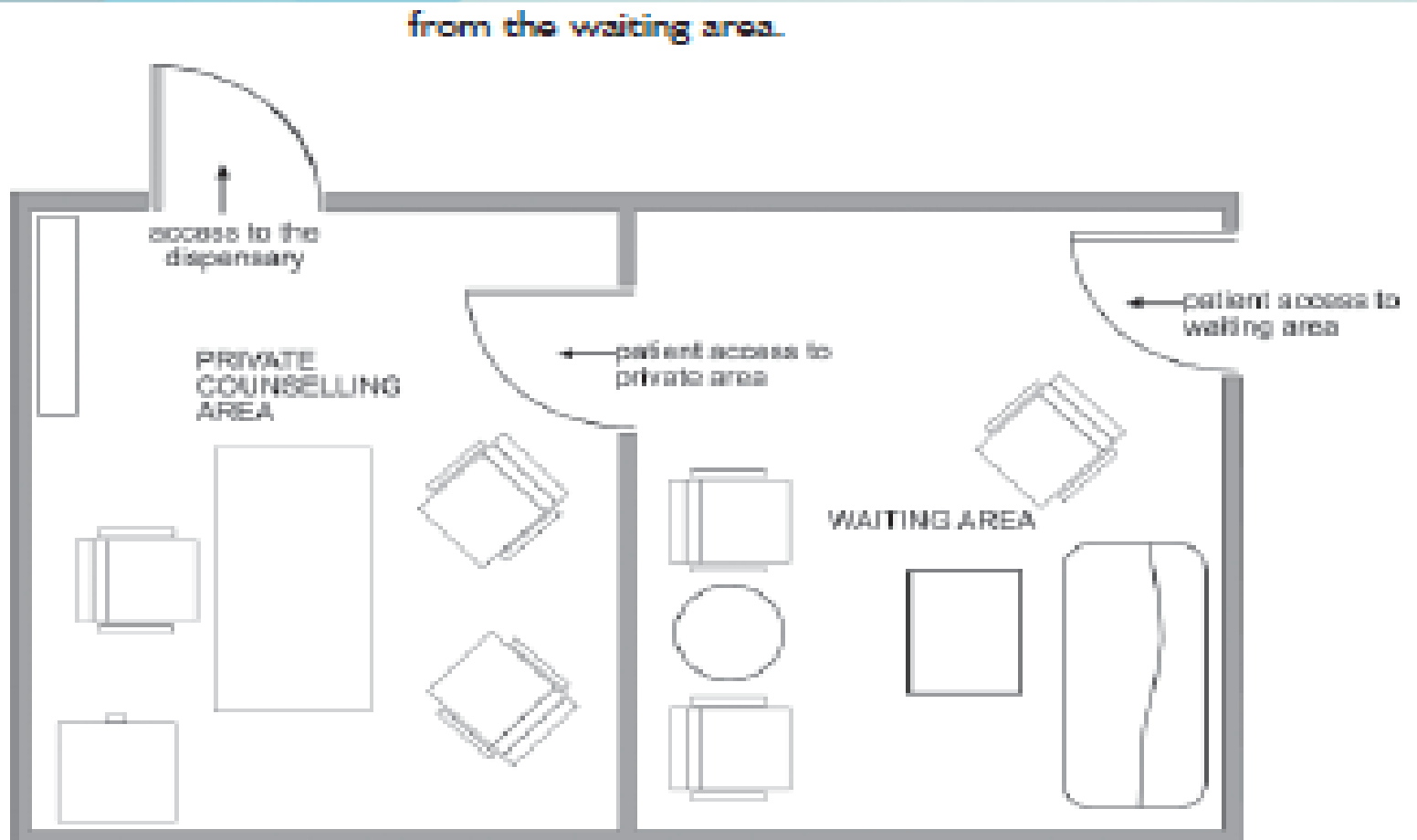

Figure 2: Private Counselling Area

# Guidelines for applicants cont...

- ▶ Enclosed waiting area with private and Consultation area combined Rule 1.2.13 (1 to 4)

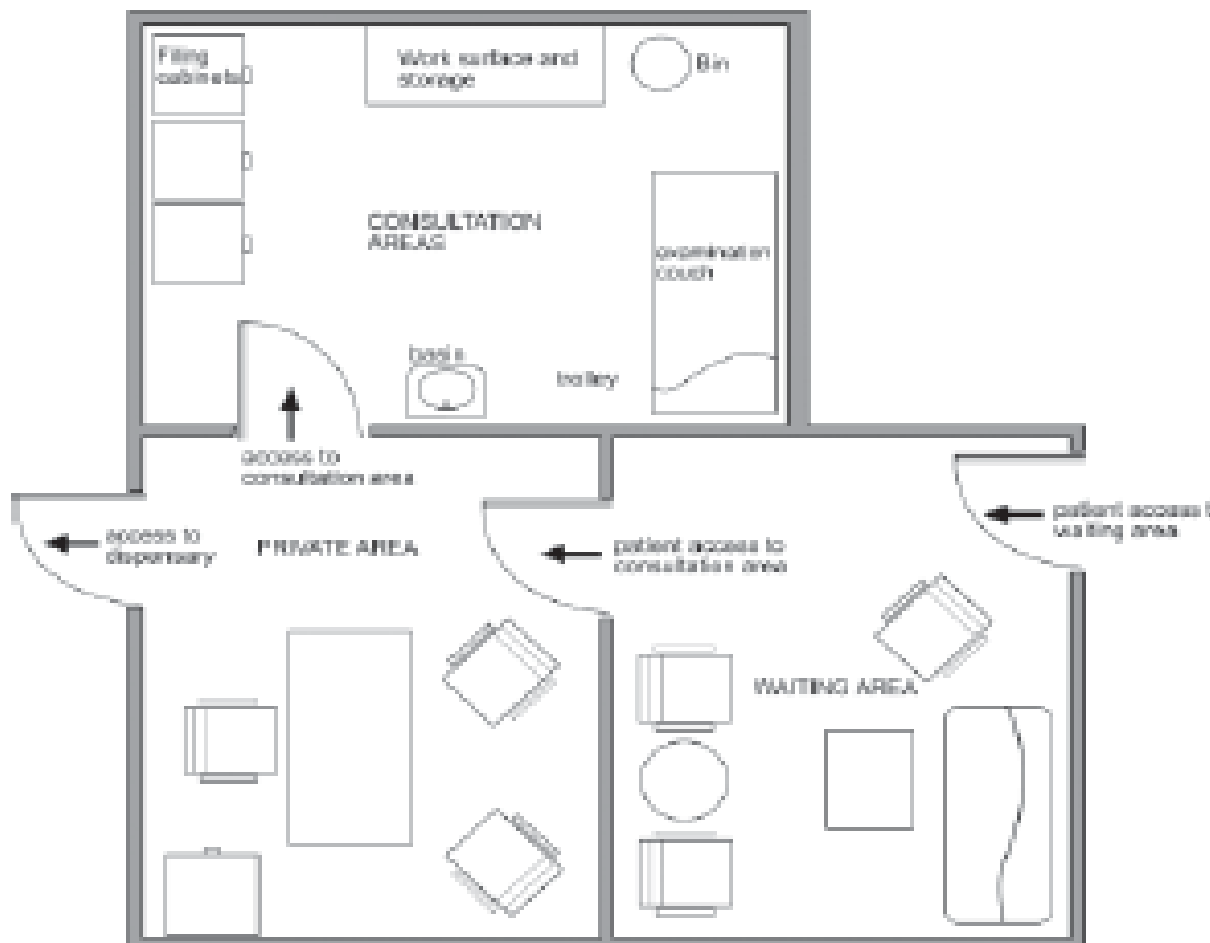

Figure 3: Consultation Area



# Guidelines for applicants cont...

- ▶ *The above measures were implemented to guide the profession but were found to be still inadequate*



# Council's approach

## ▶ Design 3D models to:

- Guide profession in license application and
- Improve compliance with requirements

## ▶ Feedback from stakeholders: Design must take into account

- Public sector requirements
- Private sector requirements
- Size and norms requirements
- NHI requirements
- CSIR (IUSS) requirements



# **Current – 3D Pharmacy design models**





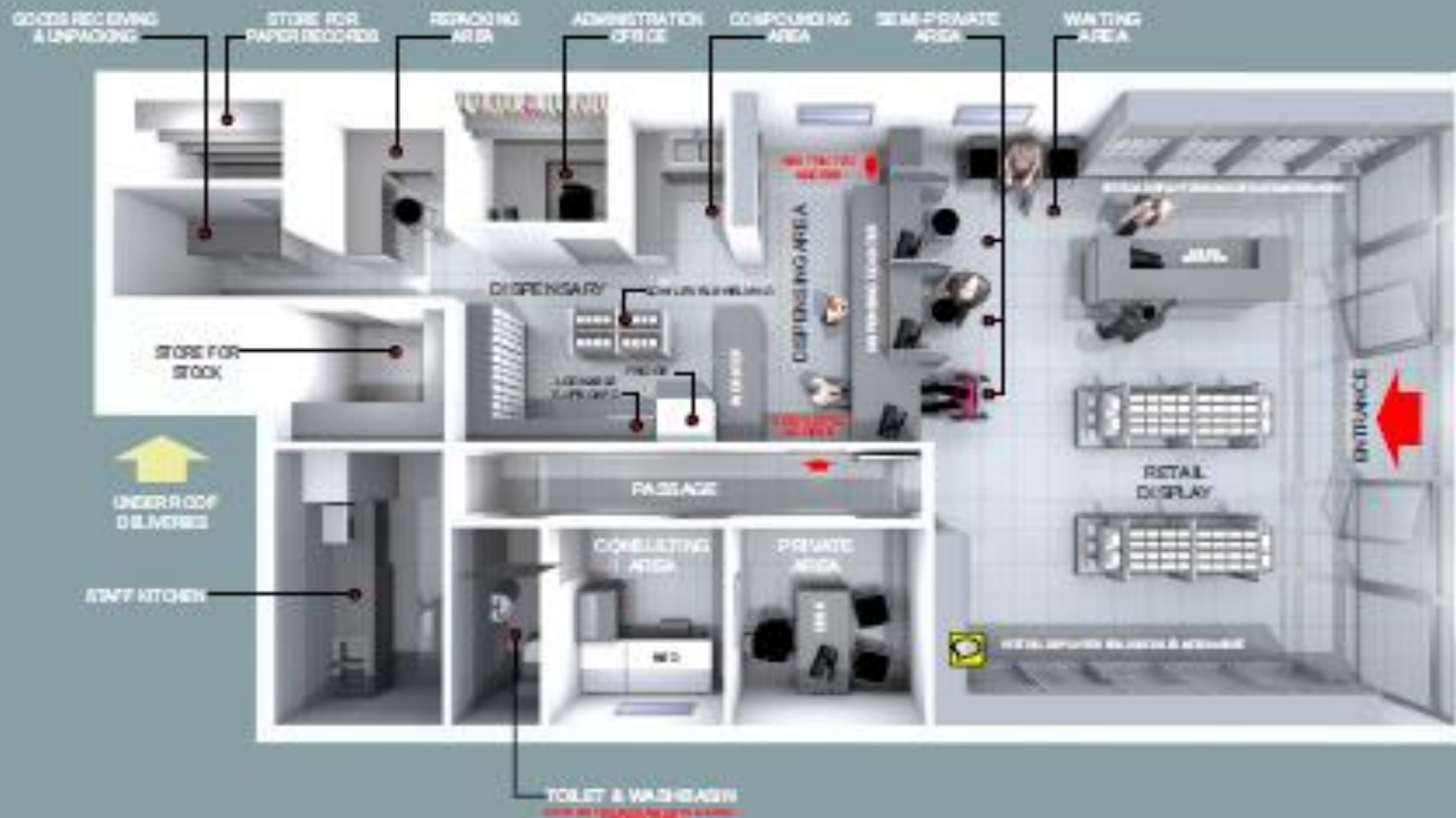







# **Current – 3D Pharmacy design models**

## **Public Institutional Pharmacy**



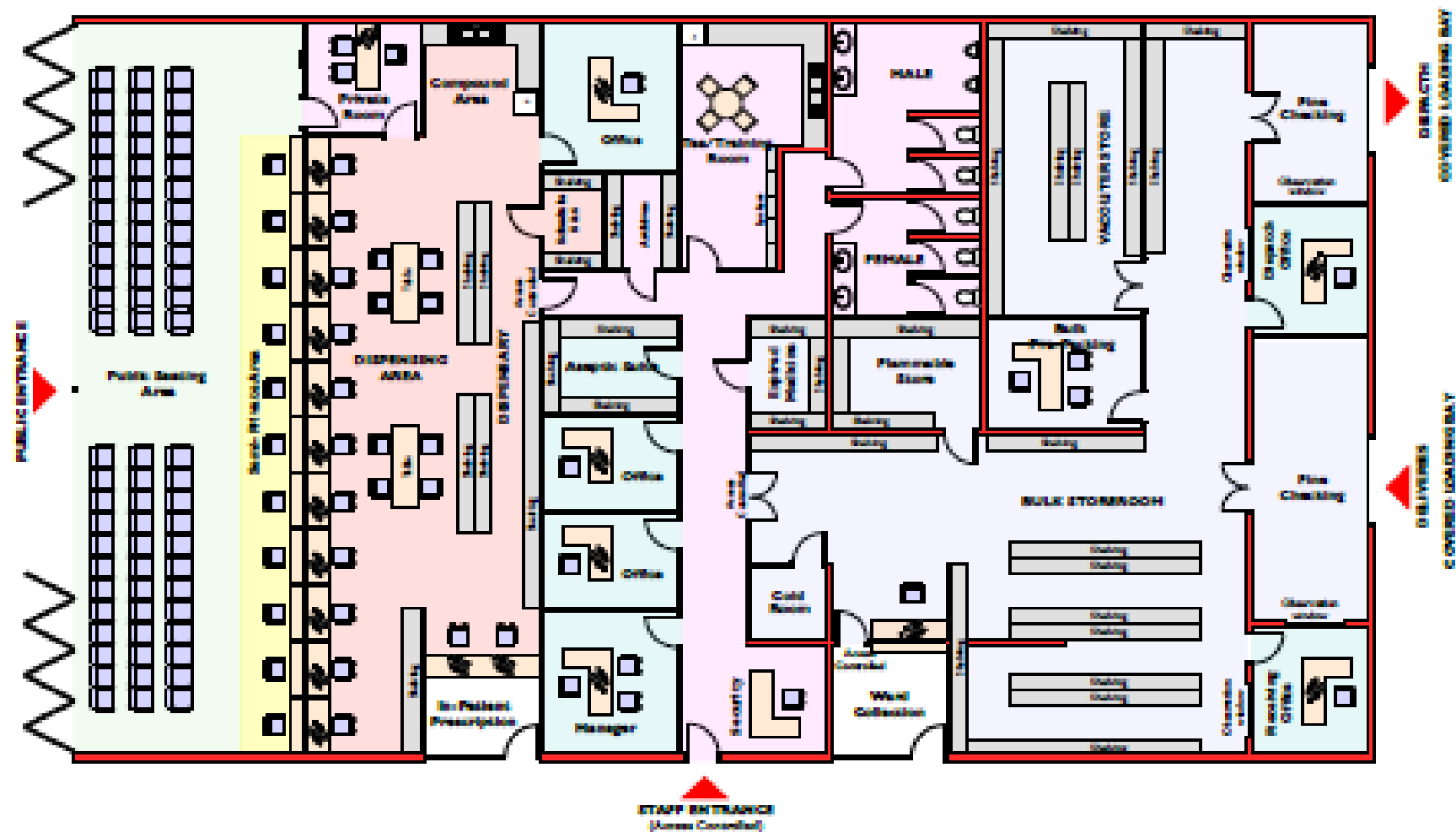

### Proposed Public Hospital Pharmacy Layout Different Zones

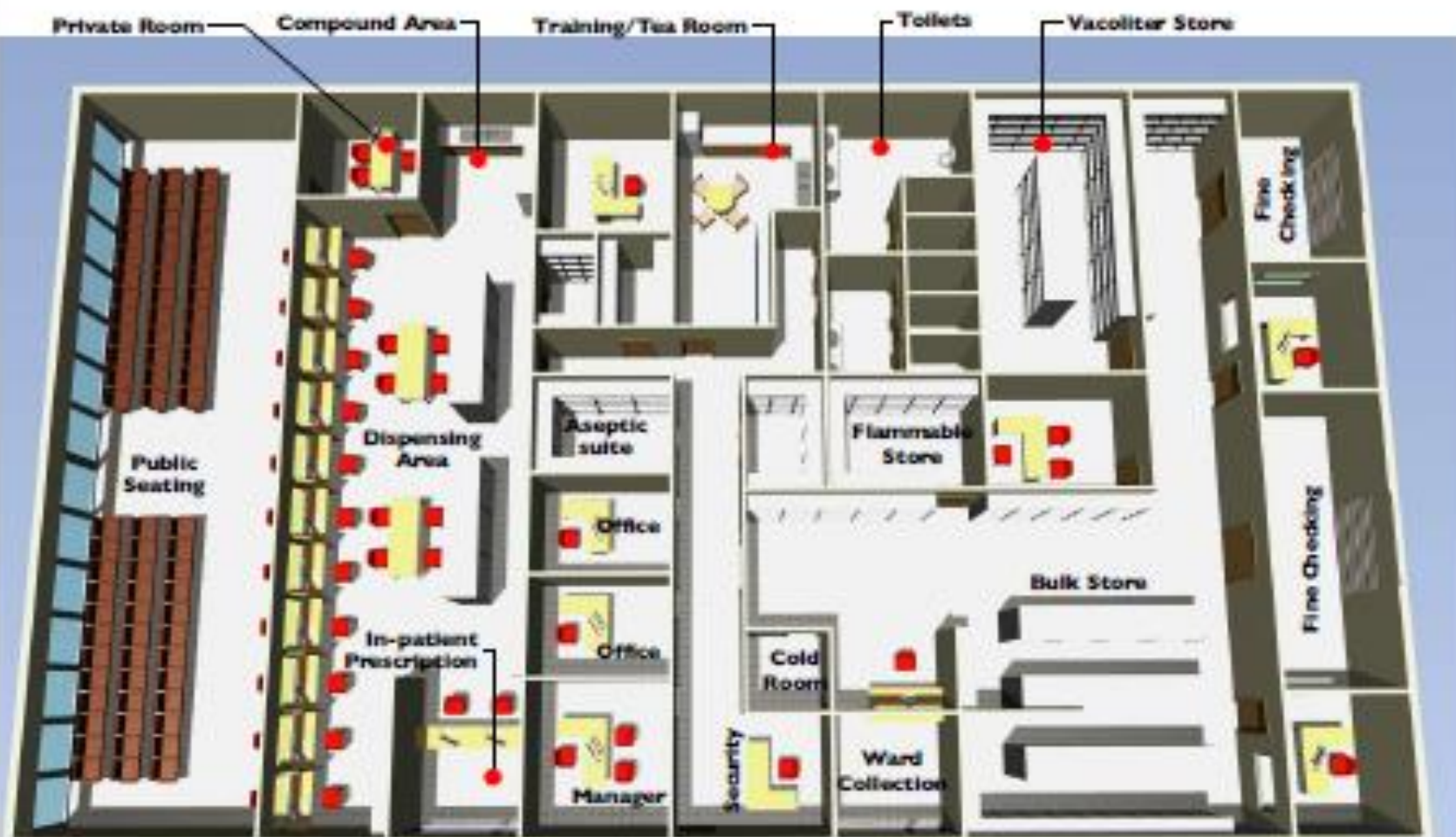

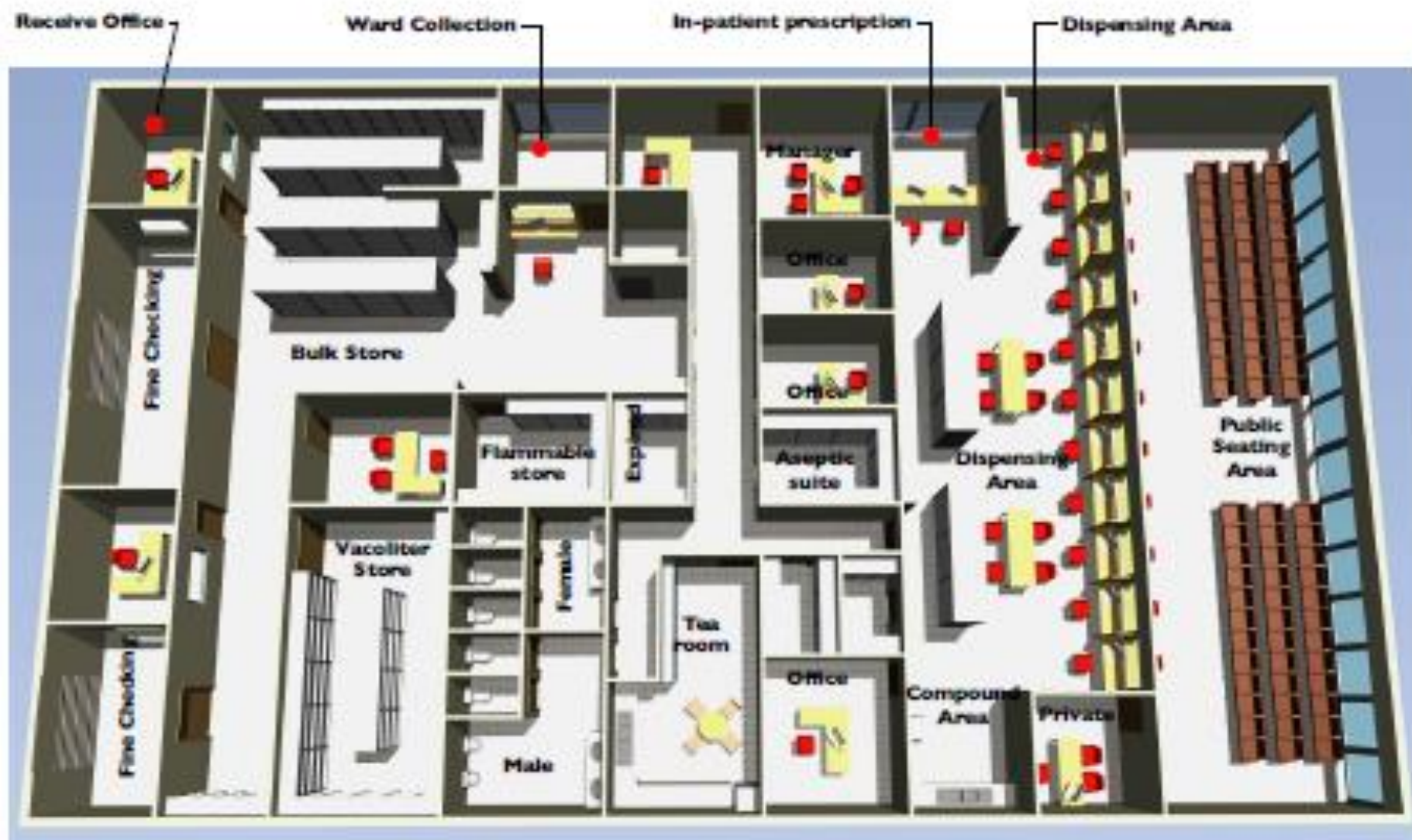

**Proposed Public Hospital Pharmacy 3D**





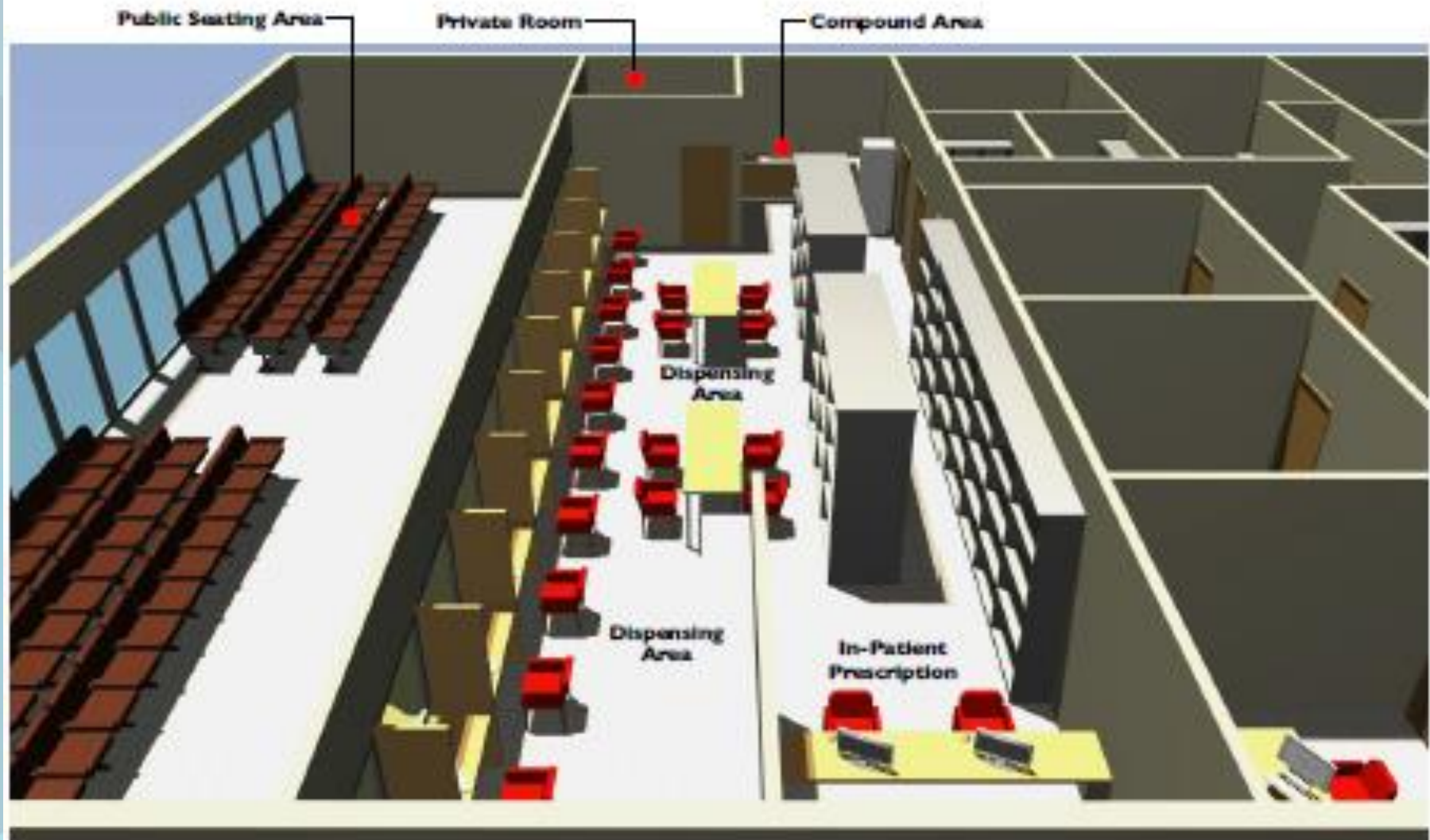

**Proposed Public Hospital Pharmacy Layout  
View on Dispensary & Seating Area**





# **Current – 3D Pharmacy design models**

## **Private Institutional Pharmacy**



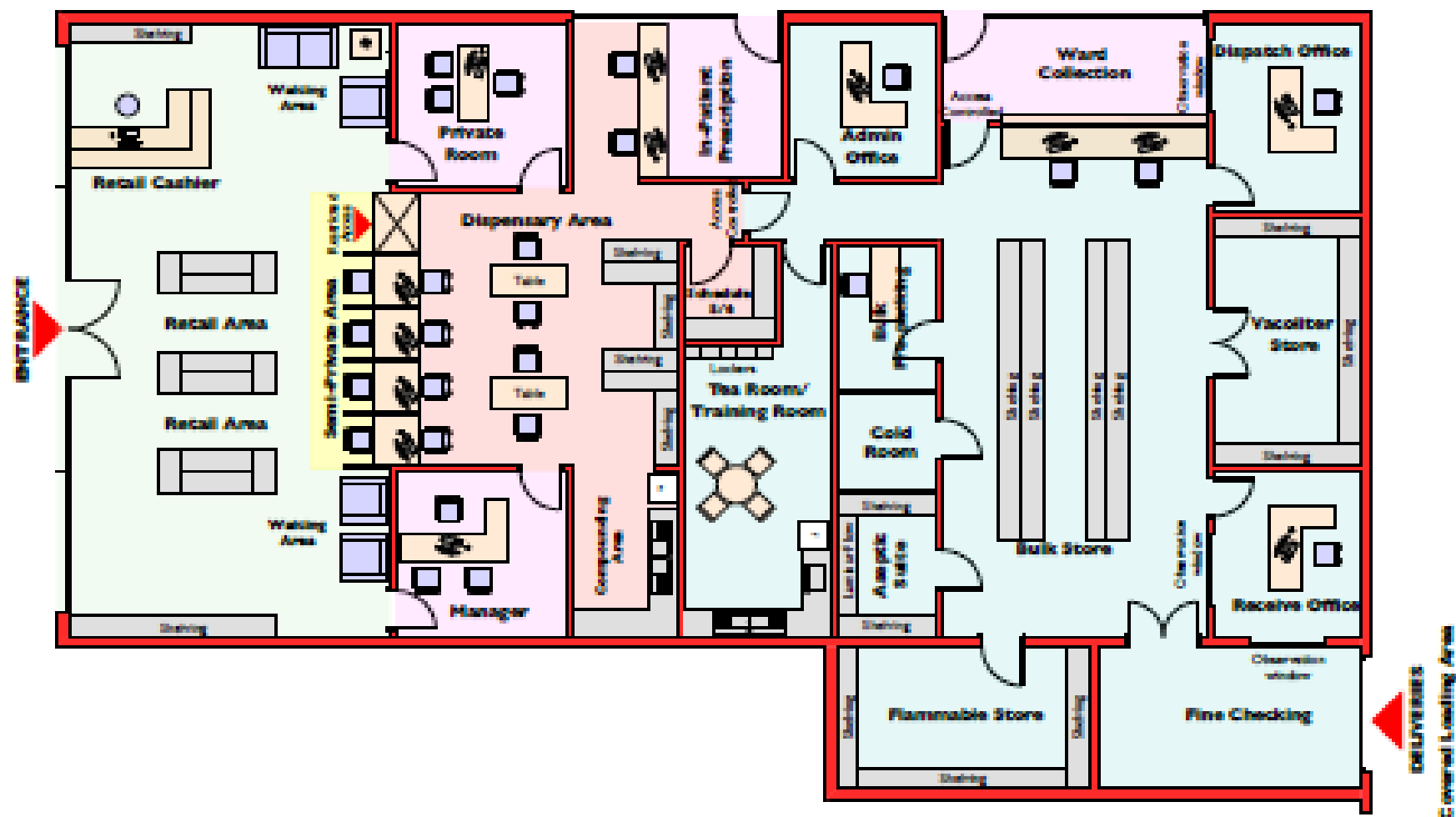

## Proposed Private Hospital Pharmacy Layout



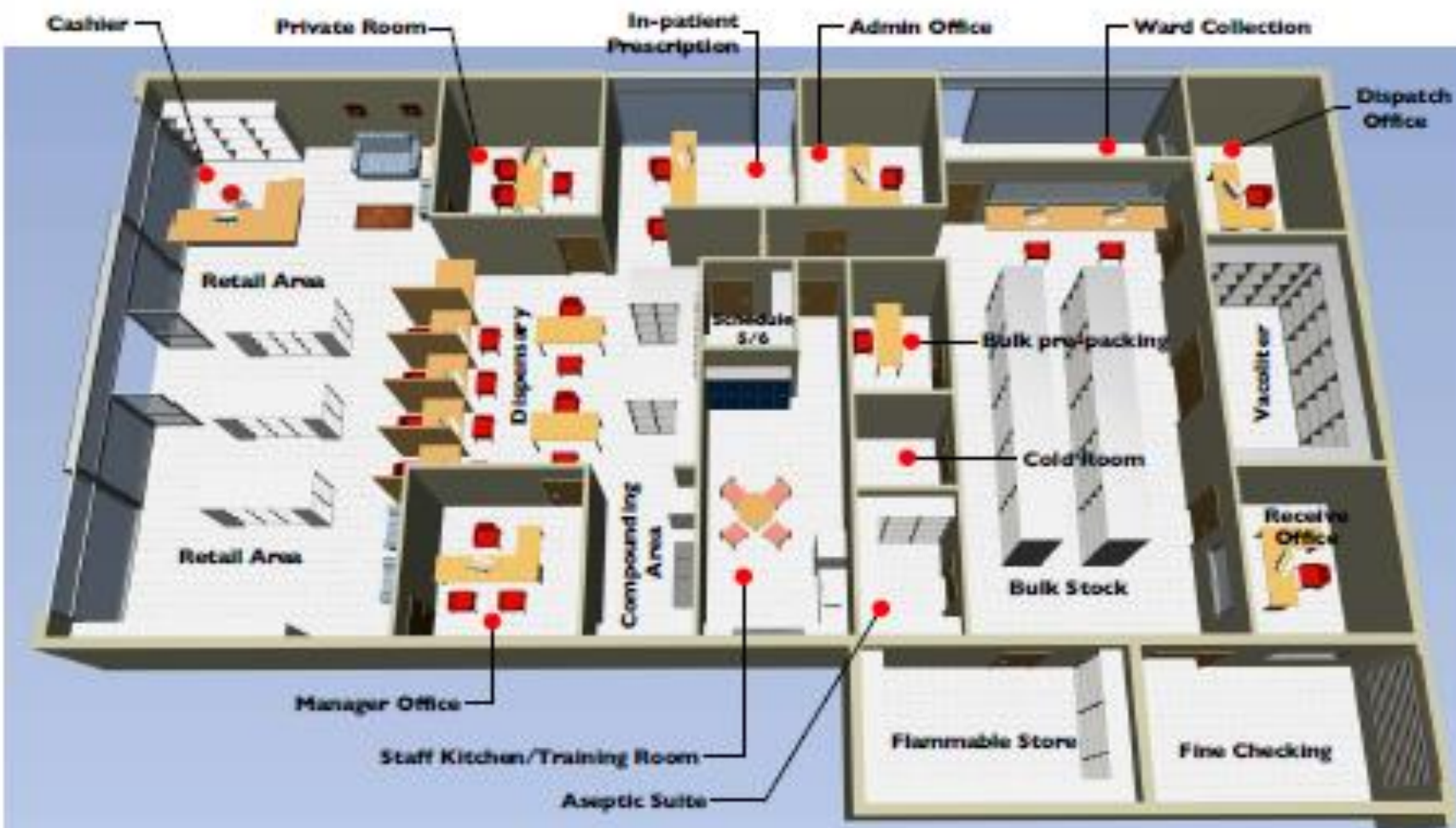

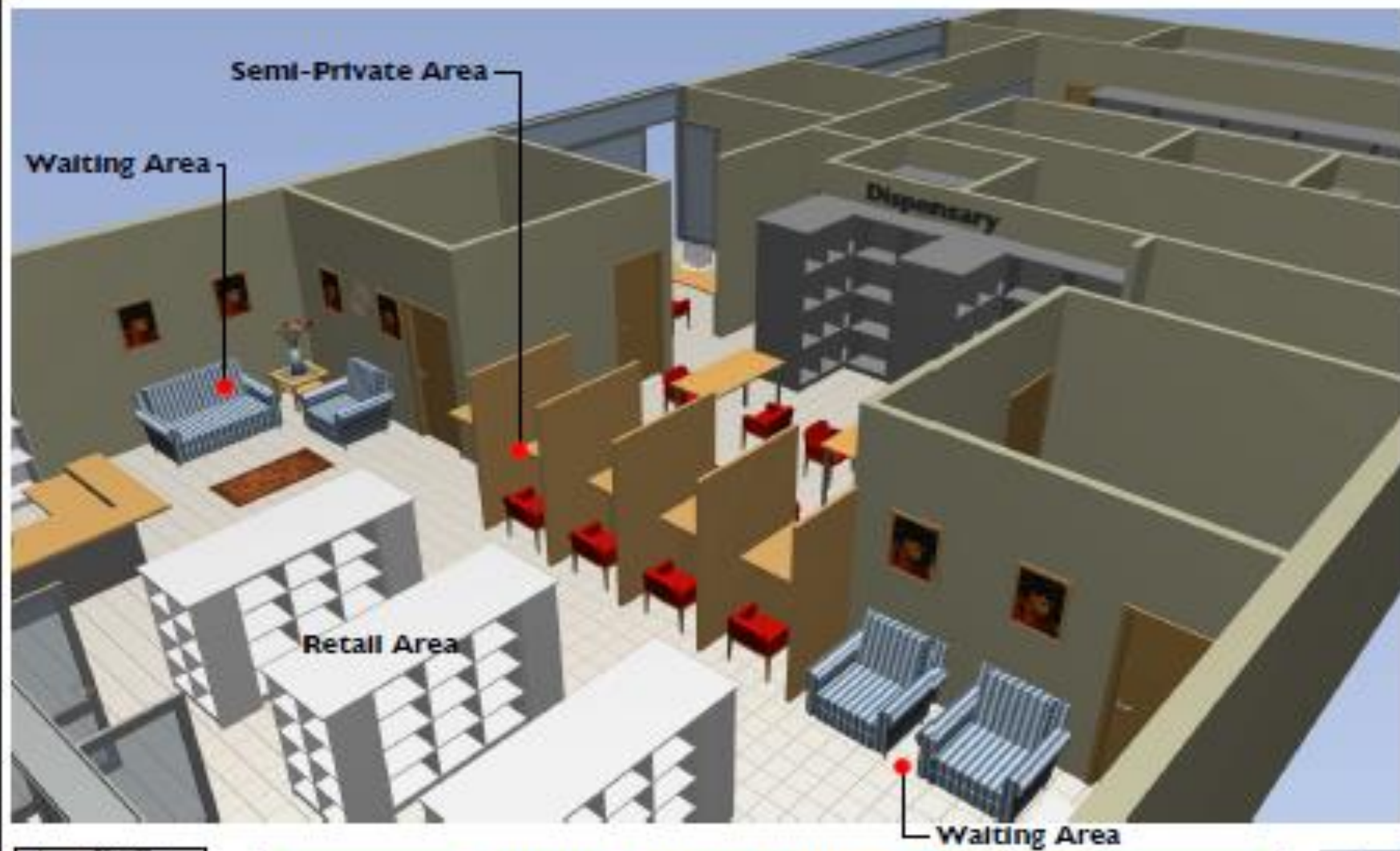





# **Future – 3D Pharmacy design models**

## **Community Pharmacy**



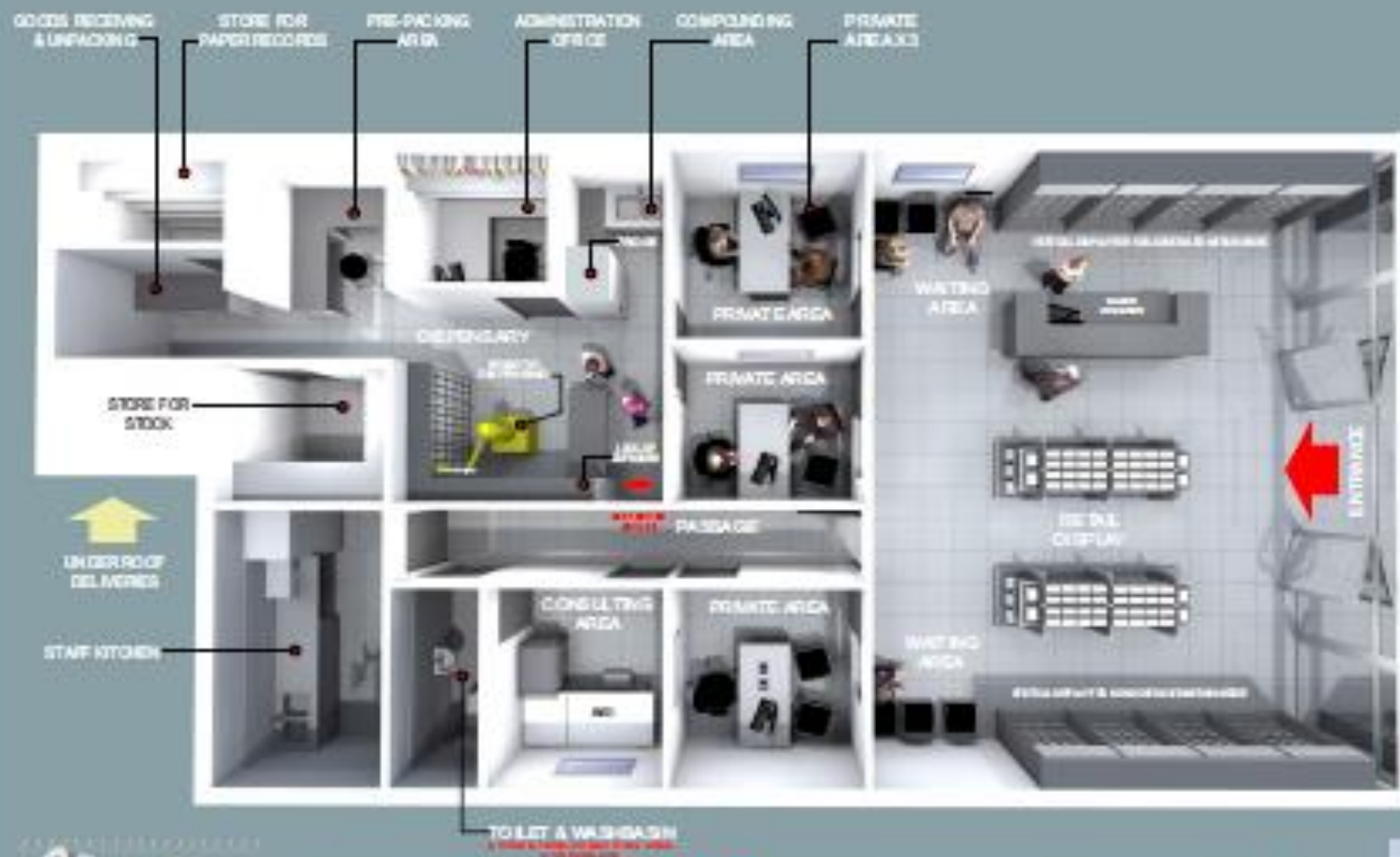





## PROPOSED **FUTURE** COMMUNITY PHARMACY 3D LAYOUT (GENERIC)



## PROPOSED **FUTURE** COMMUNITY PHARMACY 3D LAYOUT (GENERIC)

# **Future – 3D Pharmacy design models**

## **Public Institutional Pharmacy**



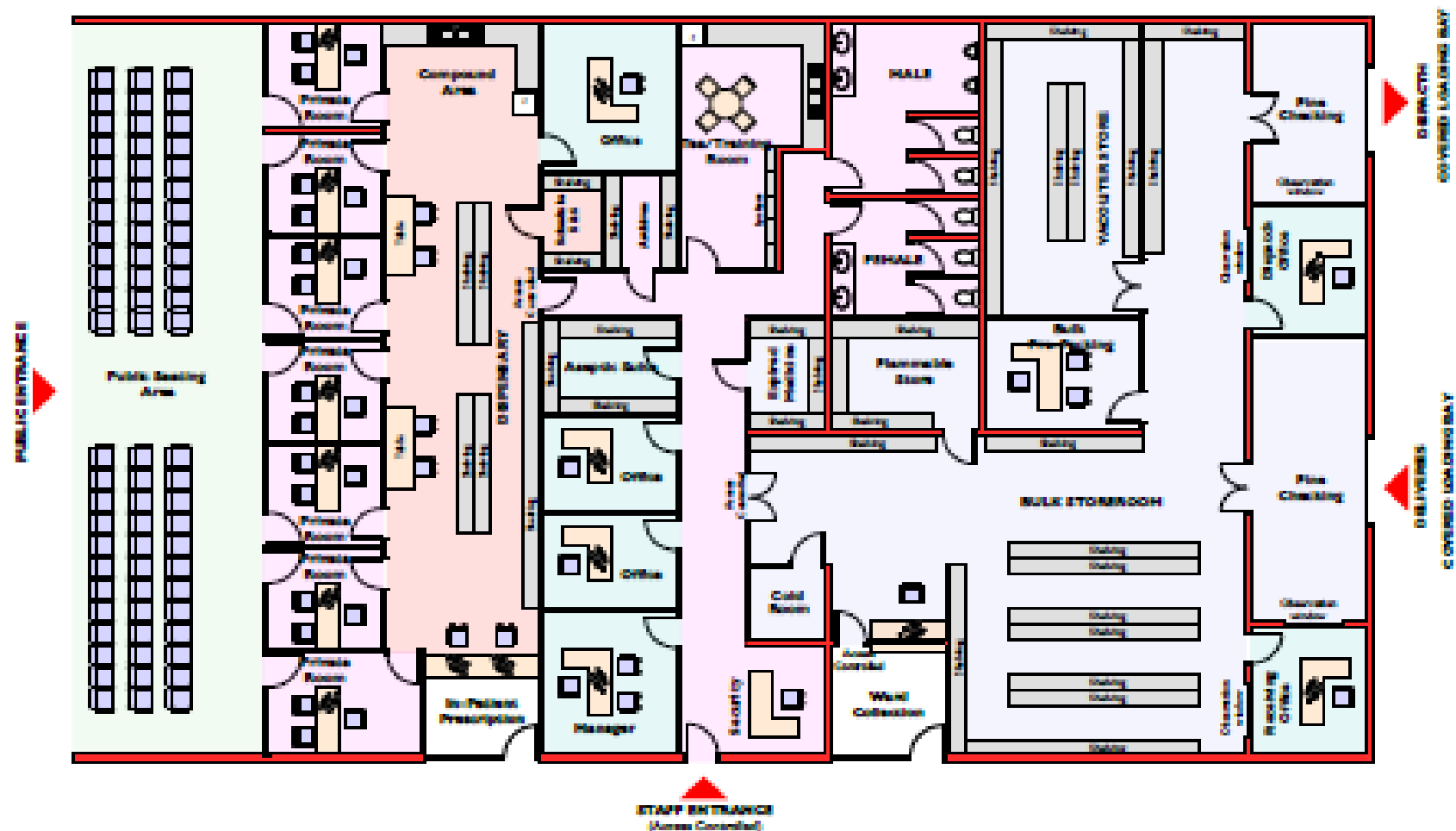

**Future Public Hospital Pharmacy Layout**  
**Different Zones**





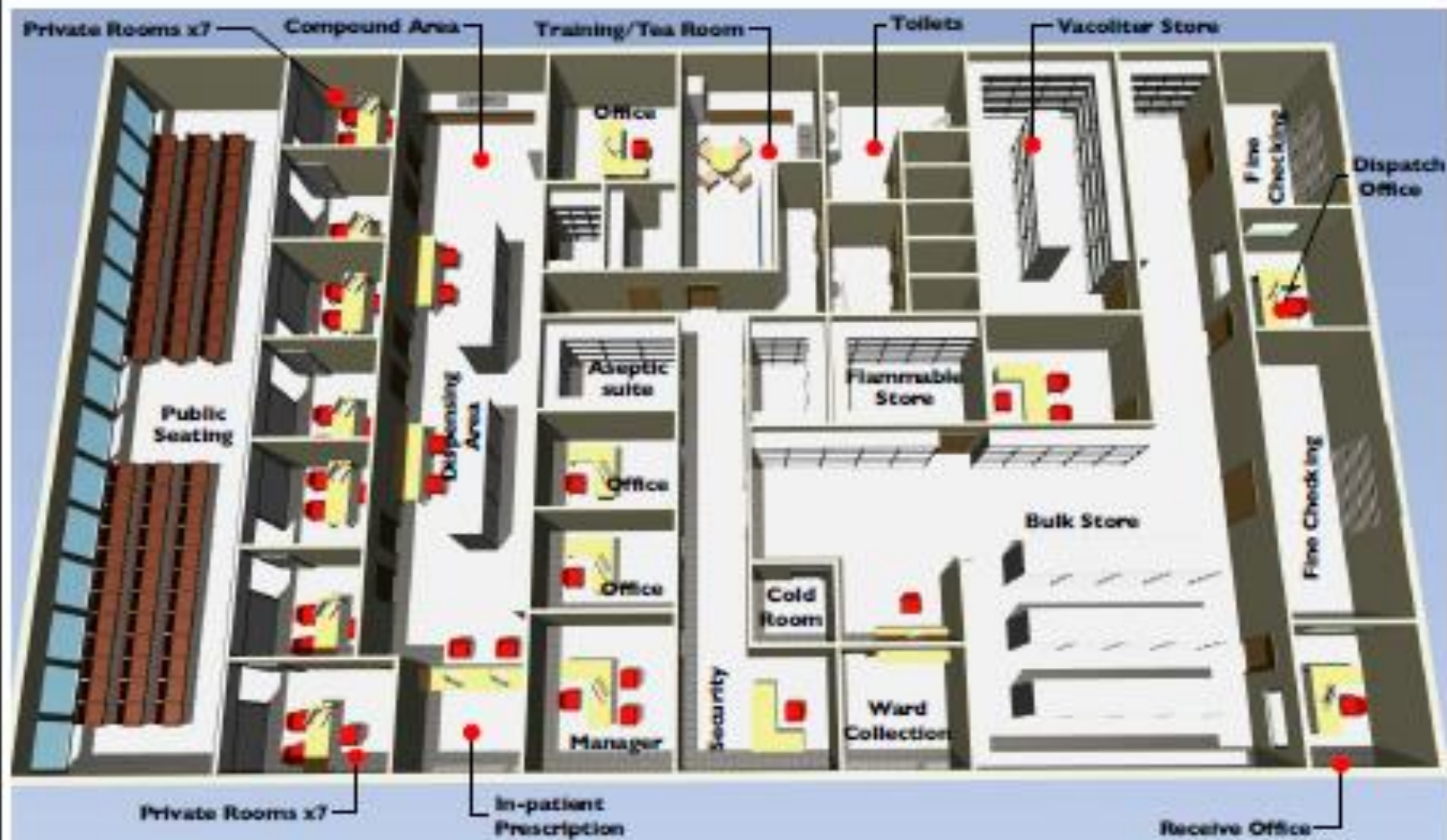

**Future Public Hospital Pharmacy 3D**

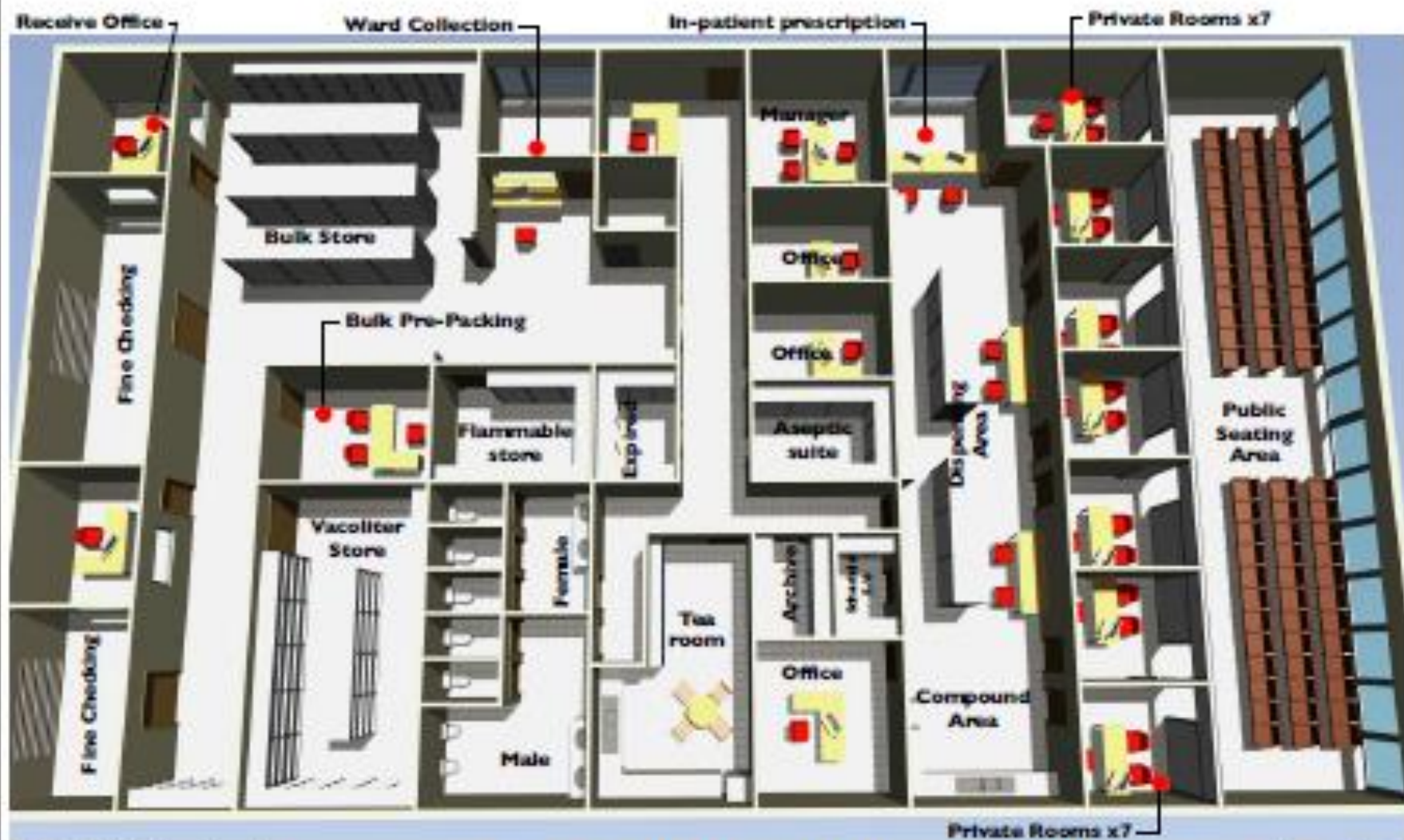





## Future Public Hospital Pharmacy Layout View from Entrance



# THANK YOU!



# CONTACT US



**086 172 7200**



**customercare@sapc.za.org**



**@OfficialSAPC**



**www.sapc.za.org**



**591 Belvedere Street,  
Arcadia, Pretoria**

